

JG Speedfit®

UNDERFLOOR

aura
heating controls



*Wireless TRV
Battery Operated
Instruction Manual*

For model:

JGTRV



speedfitUFH.co.uk

Contents

Box contents:



JGTRV



2x AA Batteries



Adapter



Instruction Manual

Instruction manual:

- Box contents
- Introduction
- Product compliance and Safety information
- Installation
- User interface
- Status/LED indication
- Installer notes

Icons used in this manual:



Safety



Important info



Your benefit

For latest PDF Instruction Manual please go to speedfitUFH.co.uk

Product Compliance & Safety Information

Introduction. Thank you for purchasing the Speedfit Aura Wireless TRV (JGTRV). The JGTRV simply replaces the passive head supplied with a standard Thermostatic Radiator Valve (TRV). The JGTRV must be used with a JGSTATW1 or JGSTATW2 Wireless Thermostat and a JGCO Wireless coordinator (all sold separately). The JGTRV can be used with the JGBR Wireless Boiler Receiver (configured to RX1) and other Aura wireless products (see below).



JGSTATW1/
JGSTATW2

Thermostat (Required)



JGCO
(Required)



JGBR
(Optional)



Wiring Centre JGWCW



Product Compliance. This product is CE compliant and meets the following EC Directives:

RoHS2 directive 2011/65/EU, Electro-Magnetic Compatibility directive 2004/108/EC and Low voltage directive 2006/95/EC.



Safety Information. Use in accordance with the regulations. The Aura JGTRV is to be used for room control in buildings.



Installation. This accessory must be fitted by a competent person, and installation must comply with the guidance, standards and regulations applicable to the location where the product is installed. Failure to comply with the relevant standards could lead to prosecution.

System Overview

To provide the best level of system control, we recommend that the JGTRV is installed with a JGBR Boiler Receiver (configured to RX1). This enables the Wireless Thermostats in the system to switch the boiler on/off whilst also opening/closing the radiator valves.



The JGTRV is modulating which means it can regulate the flow-rate through the valve. A paired Wireless Thermostat increases/decreases the flow-rate through the valve based on the difference between the set temperature and the room temperature.



Only 3 TRV's can be paired to a JGSTATW1/JGSTATW2.

Installation - General



Detach top housing by pressing a flat screwdriver into the slot as shown above.



Remove the battery cap.



Insert the batteries and replace the battery cap. Please note correct battery orientation.



Gently place the top housing onto the bottom housing. Note correct orientation.



Ready to be fitted to the radiator valve. Note: The LED will flash green and then red before eventually changing to solid red.



Optional adapter.

Installation - General

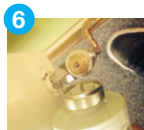

6 Place the TRV over the radiator valve.



7 Tighten the TRV (finger tight) to the radiator valve.

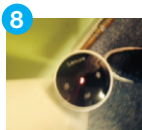

8 Check that LED is solid red.

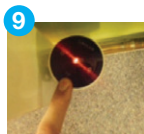

9 Press any button to commence adaptive mode.



10 Adaptation to the valve is complete once all noise and LED activity has ceased. If LED continues to flash refer to page 11.



11 The unit is now ready for pairing to the Aura thermostat.



It is recommended that pairing is done on a room by room basis.

Installation - Pairing

System setup checklist

- 1** The Wireless Coordinator must be in Pairing Mode.

Before starting the pairing, make sure the light is flashing on the Coordinator by holding the button for 5 seconds.

Please refer to the JGCO Wireless Coordinator Instruction Manual.



- 2** Ensure that the thermostat is powered up and ready for configuration and pairing.

Please refer to pages 32 and 37 in the Wireless Thermostat Instruction Manual.

- 3** If you are using the optional JGBR Boiler Receiver configured for remote boiler switching, ensure this has been powered up and the red flashing LED has gone steady.

Please refer to Boiler Receiver Instruction Manual.

Installation - Pairing

1



Press and hold the pairing button for 5 seconds.

2



Once the red LED starts flashing go to page 37 in JGSTATW1/JGSTATW2 Instruction Manual.



When pairing is successful with the JGSTATW1/JGSTATW2 thermostat the LED will go out.

User Interface

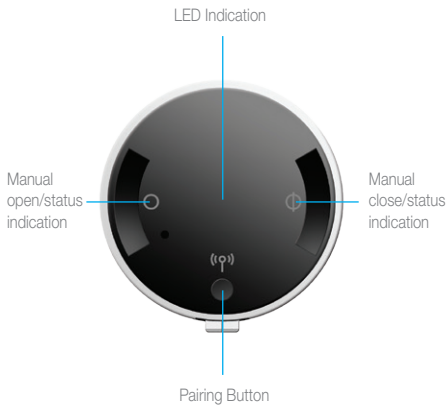

Status Indication

Manual Mode (See page 12)

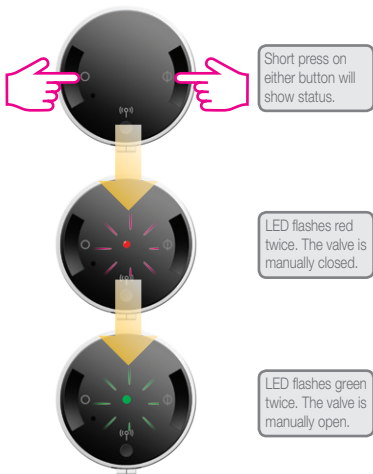

If wireless link is lost error code **-07 will show on the connected thermostat.

LED Indication

Installation Error

If there is an error in the installation the TRV LED will flash Red / Green alternately. Please remove the TRV from the radiator valve and repeat the installation steps on page 6.



Low Battery

If the battery low, the red light will flash three times every ten seconds. When replacing batteries follow steps 1 to 9 on page 5 and 6.

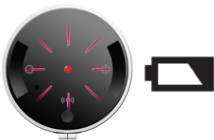

Low battery in the radiator valve will also be shown as error code **22 on the connected thermostat.

Manual Override

To remove the JGTRV from auto mode, follow steps below.



Long press to manually open TRV.



LED flashes green once and then goes out. To check status refer to page 10.



Long press to manually close TRV.



LED flashes red once and then goes out. To check status refer to previous page.



Short press to return to Auto mode. Red LED will flash once to confirm that the unit is in AUTO.

Technical Detail

Model	JGTRV
Type	Hydraulic Radiator Valve DC Motor M30 x 1.5
Input	3 push buttons. Auto/Open/Close/Pair
LED Indicator	Bi-Colour, Red/Green
Valve Adaptation	Automatic
Power Source	2 x AA Batteries
Battery Life	12 Months
Control Method	Modulating
Communication	Zigbee - 2.4GHz
Operating Temperature	0°C to 50°C
Storage Temperature	-20°C to 60°C

John Guest Speedfit Limited

Horton Road, West Drayton, Middlesex UB7 8JL, England.

Tel: 01895 449233

Fax: 01895 420321

speedfitUFH.co.uk

Technical Help Desk: 01895 425333

 **John Guest**[®] and *Speedfit*[®]

The above namestyles are all trademarks of John Guest International Limited.

© **John Guest International Limited 2016. All rights reserved.**

Z2105/424/1016